



St. Stephens Road, Cheltenham, GL51 3AD

£340,000

🛏️ 2 🚿 1 🚪 1



- Two double bedrooms
- First floor apartment
- Tivoli location
- Large entrance hall
- Ample storage throughout
- Ensuite in main bedroom
- Fitted wardrobes in second bedroom
- Allocated parking space
- Communal garden
- Council Tax Band: C



This breathtaking two bedroom Georgian first floor apartment is in the perfect area of Tivoli and is in an ideal location close to amenities, schools and the Hatherley Park.



FIRST FLOOR  
802 sq.ft. (74.5 sq.m.) approx.

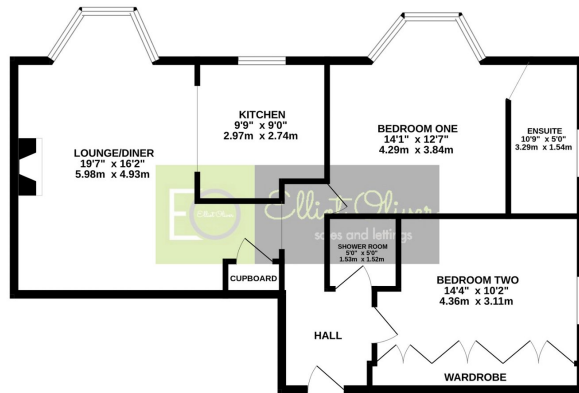

TOTAL FLOOR AREA: 802 sq.ft. (74.5 sq.m.) approx.  
While every effort has been made to ensure the accuracy of the description contained herein, measurement of plots, volumes, areas and any other facts are approximate and the responsibility is taken for any error, omission or misstatement. This plan is for guidance purposes only and should be used as a guide for the prospective purchaser. The services, fixtures and fittings shown have not been tested and are not guaranteed as to their quality or efficiency and can be given. Please see Energy C1022

Energy Efficiency Rating		
	Current	Potential
Very energy efficient - lower running costs		
(92 plus) <b>A</b>		
(81-91) <b>B</b>		
(69-80) <b>C</b>		80
(55-68) <b>D</b>	68	
(39-54) <b>E</b>		
(21-38) <b>F</b>		
(1-20) <b>G</b>		
Not energy efficient - higher running costs		
<b>England &amp; Wales</b>	EU Directive 2002/91/EC	



Elliot Oliver Sales  
 101 Promenade, Cheltenham GL50 1NW  
 01242 321091  
 www.elliottoliver.co.uk

