



Marshalla Parade, Cheltenham, GL50 4EH

£300,000

🛏️ 4 🚿 2 🛋️ 1



- Four Bedroom
- Town House
- Characterful Bay Window
- Mid-Terraced
- Garage
- Walking Distance To The Town Centre



This is a well proportioned four bedroom terraced property located within walking distance to the Town Centre and the Brewery complex. This would be a great investment property of a family looking for a house close to the town centre.

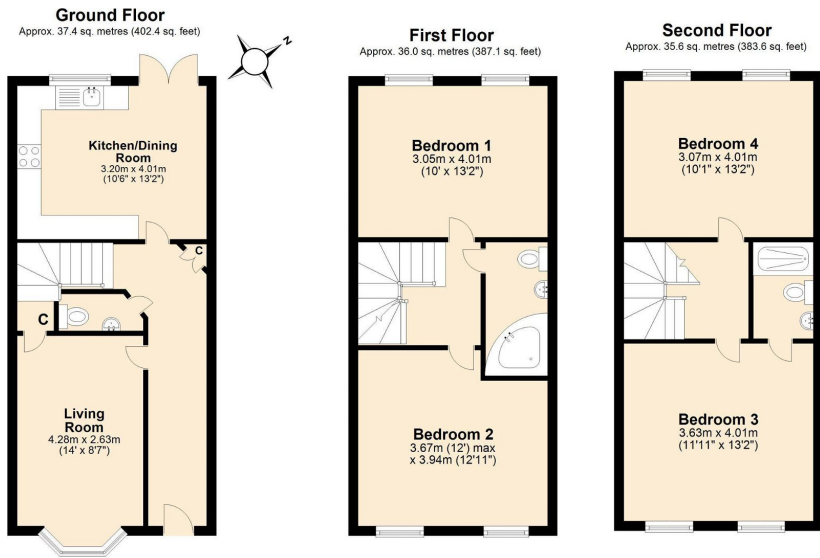

Total area: approx. 109.0 sq. metres (1173.1 sq. feet)

This plan is not to scale. For guidance purposes only. Plan produced using PlanUp.

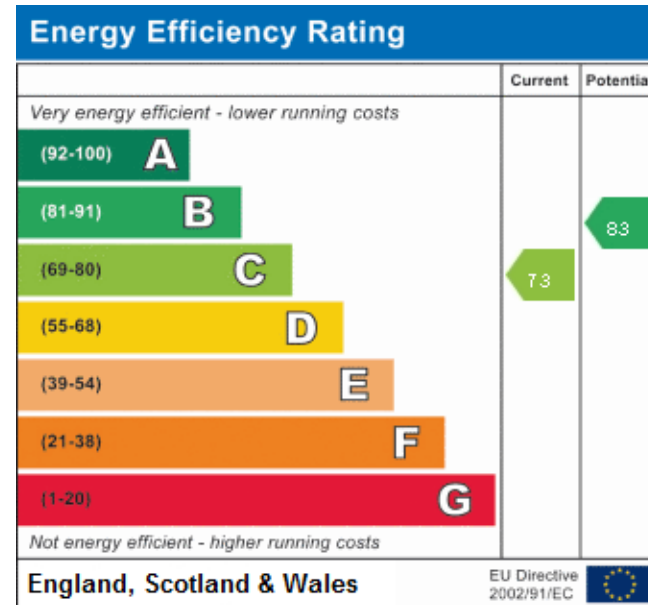

Elliot Oliver Sales
 101 Promenade, Cheltenham GL50 1NW
 01242 321091
 www.elliottoliver.co.uk

