



Lansdown Road, Cheltenham GL51 6QB

Offers Over £190,000

🛏️ 1 🚿 1 🚗 1

- One Double Bedroom
- Grade II Listed Building
- Bath with shower head attached
- Off Road Parking
- Council Tax Band A
- Top floor Apartment
- Large open plan living/dining area
- Spacious throughout
- No Onward Chain



A charming one bedroom top floor apartment located on the popular Lansdown Road and has easy transport links to the Town Centre and Promenade. Upon entry you are welcomed into a large hallway, that leads straight into the open plan living/dining area. Separate to this you are lead to the kitchen that is fitted with a variety of integrated appliances and plenty of countertop space. To the front of the property there is a great double sized bedroom benefitting a beautiful skylight that lets in lots of natural light and a lovely tiled bathroom complete with bath and shower. This property has no onward chain.



GROUND FLOOR
462 sq.ft. (42.9 sq.m.) approx.

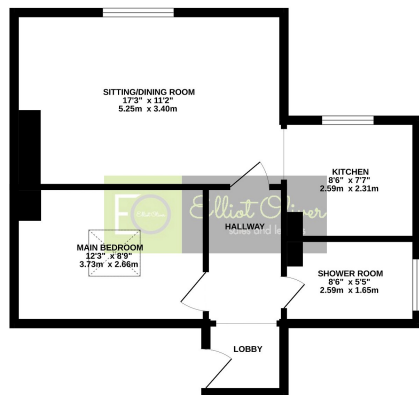

TOTAL FLOOR AREA - 462 sqft. (42.9 sq.m.) approx.
Measurements are approximate and should not be relied upon for contractual purposes. Measurements are taken from the internal face of walls and doors. Measurements are taken from the internal face of walls and doors. Measurements are taken from the internal face of walls and doors. Measurements are taken from the internal face of walls and doors.

